

**AVK RECOIL CHECK VALVE, SINGLE DOOR, PN 16****641/11  
003**

Recoil Check valve, designed according to manufacturer standard, Standard flange drilling to EN1092-2 (ISO 7005-2)

**Use:** For water and neutral liquids to max. 70°C  
**Hydraulic tests:** Seat: 1.1 x PN, Body: 1.5 x PN(PN16) according to EN12266-1  
**Applicable standards:** Drilling to EN 1092-2:PN16  
**Options:** PN25, Limit/Proximity Switch

**Materials:**

Body inlet & outlet	Ductile Iron EN 1563 EN-GJS-500/7
Cover, Cover stopper	Ductile Iron EN 1563 EN-GJS-500/7
Disc	Ductile Iron EN 1563 EN-GJS-500/7
Face ring, seat ring	Aluminum bronze EN 1982 CC331G
Hinge pin	Stainless steel EN 10088-1:(W1.4057)/ASTM A276-431
Air vent	Aluminum bronze EN 1982 CC333G
Bush	Aluminum bronze EN 1982 CW307G
Gasket	Nylon
O-cord	EPDM rubber WRAS
Fasteners	Zinc plated steel
Coating	Internal and external blue fusion bonded epoxy(250 microns) WRAS



For further details see section "Technical Information".  
The designs, materials and specifications shown are subject to change without notice due to the continuous development of our product programme.

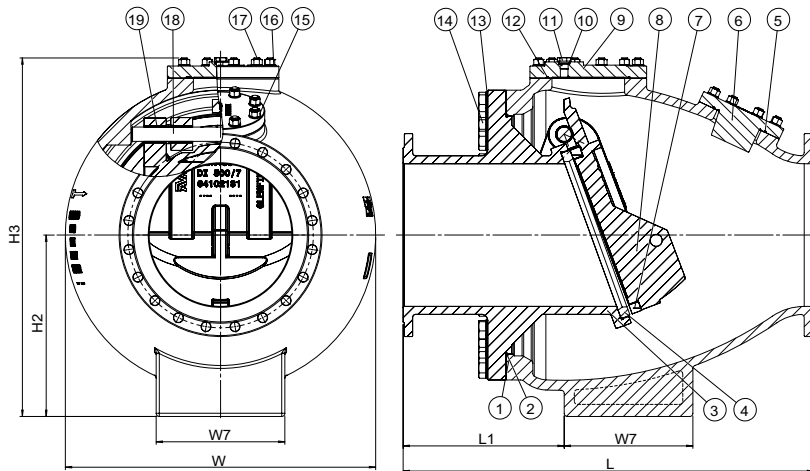

### Component list

1. Body outlet	11. Air vent
2. O-cord	12. O-cord
3. Body inlet	13. Washer
4. Seat ring	14. Hex screw
5. O-cord	15. Nut
6. Stopper	16. Washer
7. Face ring	17. Stud
8. Disc	18. Hinge pin
9. Cover	19. Bush
10. Gasket	

### Reference nos. and dimensions

AVK ref. nos.	DN mm	H2 mm	H3 mm	L mm	L1 mm	W mm	W7 mm	Theoretical weight kg
641-0350-11-100050	350	457	935	1219	469	816	305	882
641-0400-11-100050	400	457	935	1219	469	816	305	890
641-0450-11-100050	450	572	1131	1295	508	979	406	1295
641-0500-11-100050	500	660	1313	1473	546	1143	457	1986